

Ezy-Drink® Lead Safe™ Remote Push Button Drinking Bubbler Tap W/ Square Adaptor - FI

PRODUCT CODE:
- 170.32.13.90

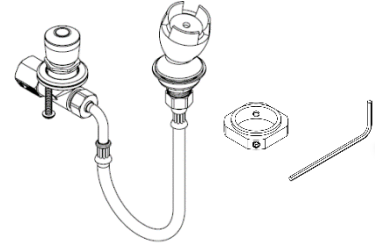

For Watermark and/or WELS information of KITS, refer to each individually certified component.

Item Codes:	Description	Watermark	WELS
170.32.13.90*	Ezy-Drink® Lead Safe™ Remote Push Button Drinking Bubbler Tap W/ Square Adaptor - FI	-	-
Components:			
170.81.13.01	Ezy-Drink® Lead Safe™ Remote Push Button Drinking Bubbler Tap - FI	YES	YES
-	BS Square Adaptor, Grub Screws & Hex Key	N/A	N/A

Notes:

1. N/A—Not applicable.
2. * — The item is a KIT.
3. Installation instructions for both components are included in the documentation for 170.81.13.01.
4. Some kit components may be purchased separately.

INSTALLATION

IMPORTANT: Galvin Engineering products must be installed in accordance with these installation instructions and in accordance with AS/NZS 3500, the PCA and your local regulatory requirements. Water and/or electrical supply conditions must also comply to the applicable national and/or state standards. Failing to comply with these provisions shall void the product warranty and may affect the performance of the product.

WARRANTY

Galvin Engineering products are covered under our Manufacturer's Warranty. Galvin Engineering products must be installed in accordance with the installation instructions and in accordance with AS 3500 and NCC Volume Three, relevant Australian Standards and local authorities applicable to product being installed. Water and electrical supply conditions must also comply to the applicable national and/or state standards, failing to comply with these provisions may void the product warranty and affect performance of the product.

Please visit www.galvinengineering.com.au to view the full warranty, our Installation Compliance and Maintenance & Cleaning information as well as any other additional information.